

# RPs' information 6590658

Call out	Part Number	Description	Qty	Material
1	6590658084	TOSS PILLOW SEW KIT	1	Fabric
9	6590658031	CHAISE PAD	1	Fabric
12	427625RP	POLY CUSH	1	FOAM, LMF
17	427629RP	POLY BK CHAISE	1	FOAM, LMF
18	427630RP	POLY OTTO	1	FOAM, LMF
24	6590658181	LAF IN/OUT ARM	1	Fabric
34	6590658048	COMPLETE IN/OUT BACK	1	Fabric
43	6590658021	SEAT PLATFORM	1	Fabric
46	31781P1	ROUND PLASTIC LEG 1/P	4	Plastic
57	6590658384	TOSS PILLOW SACK W/FIBER	1	Fabric, Fiber
76	6590658337	SMALL OTTOMAN/FOOTREST UPHOL	1	Fabric
80	6590658341	OUTSIDE BACK SKIRT FLAP	1	Fabric
102	11PWR3368MKRP	-11 PWR 3368 KAIDI MECH	1	Metal
145	31442RP	3368 KAIDI MOTOR	1	Plastic, Metal
148	30383RP	POWER SUPPLY KIT W/DC CBL-1ST	1	Plastic, Metal
149	76796RP	KD BRACKET AND CLIP ASSEMBLY	2	Metal
165	32055RP3	P2/P3 HEADREST MOTOR PLASTIC MTR SHAFT	1	Plastic, Metal
173	32054RP1	P2 (THR) MECH -14 PLASTIC MTR SHAFT	1	Metal
357	30651RP	FIBER RECYCLED BROWN	5	Fiber
400	74843RP	FURNITURE CONNECTOR	2	Metal

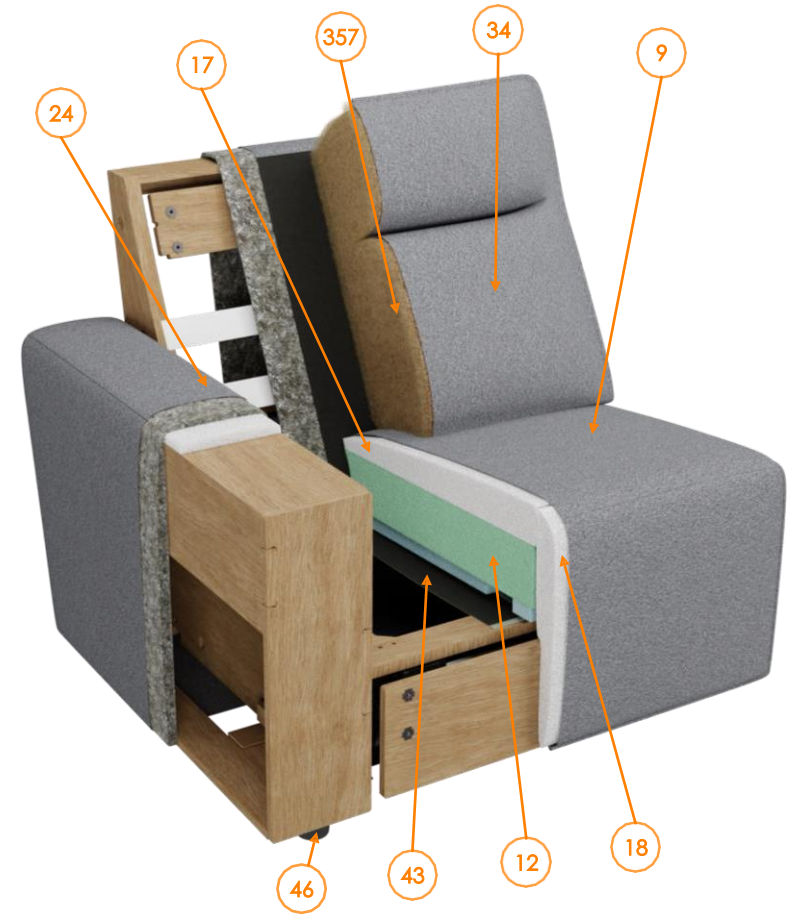

Wanek: 30660RP3 -> 32055RP3 (09/17/25)  
 US: 30660RP3 -> 32055RP3 (11/30/24)

Wanek: 30659RP1 -> 32054RP1 (09/17/25)  
 US: 30659RP1 -> 32054RP1 (11/30/24)

# RPs' information 6590658

Call out	Part Number	Description	Qty	Material
419	74018RP	HDWE 1/4-20X.75 WSHRHD5/16	8	Metal
426	77075RP	1-4-20X3/4 HX HD ZINC PRECT80	4	Metal
478	32476RP	BTN CNTL RSF USB-AC KAIDI RPOL	1	Plastic, Metal
499	73507RP	BOLT 1/4-20X3/4 INCH	4	Metal
547	8001RP	4 X 3/4 FH PHL TAP BLK	4	Metal
653	31865RP	POWER MOTION TESTER CABLE	1	Plastic, Metal
654	32051RP	POWER MOTION TESTER LIGHT	1	Plastic, Metal

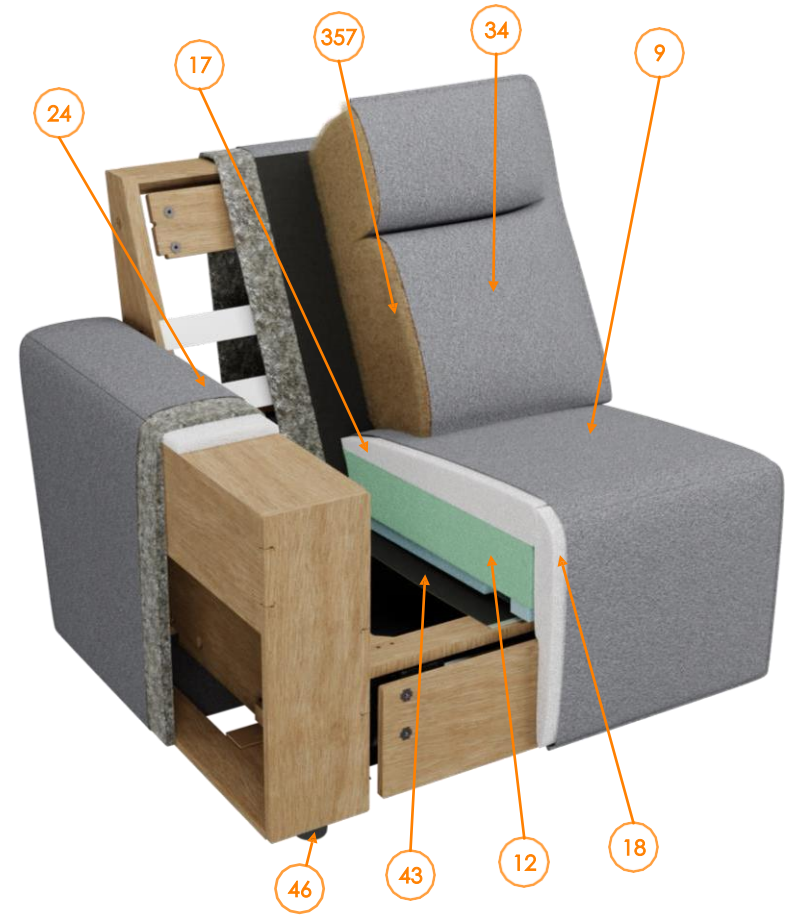

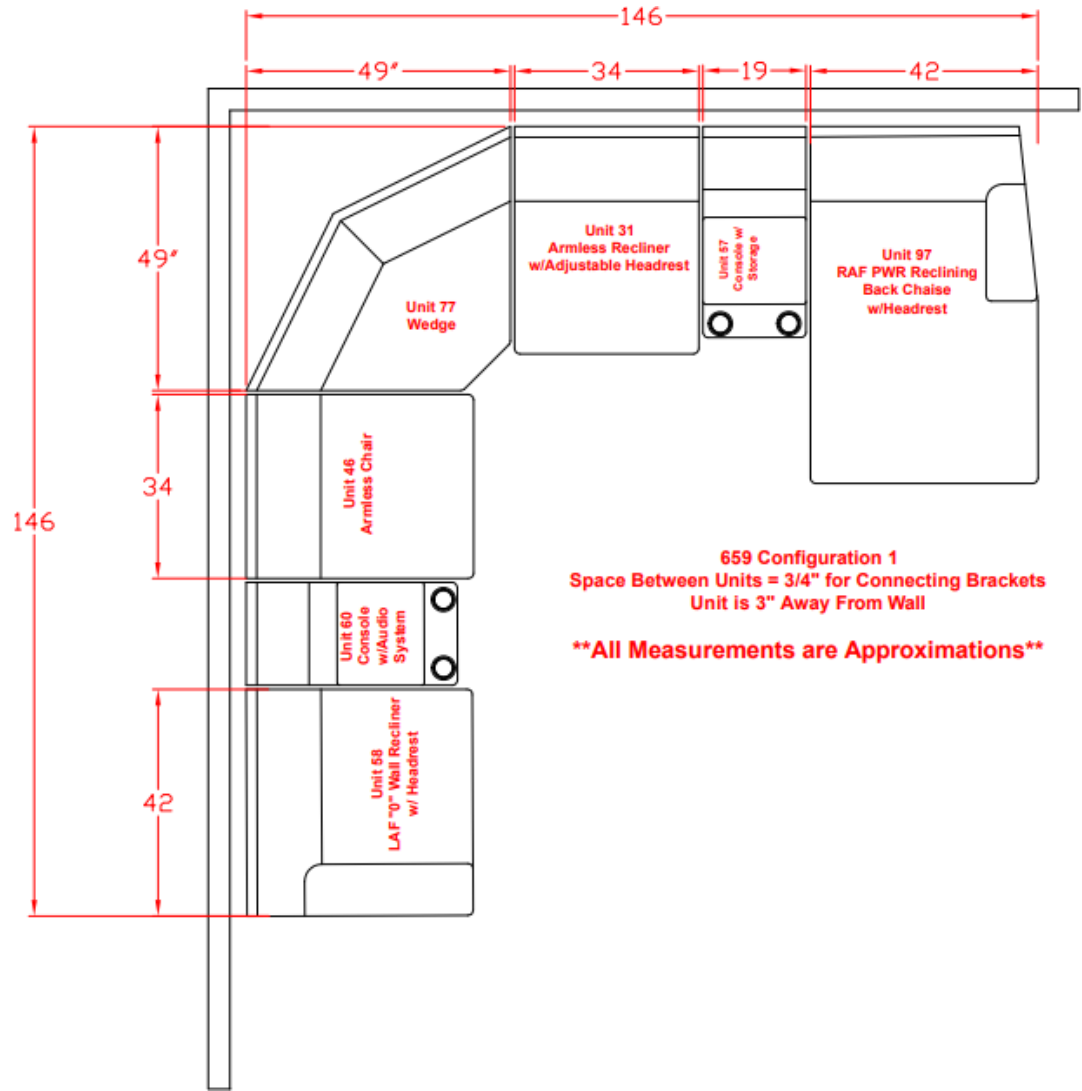

**659 Configuration 1**  
 Space Between Units = 3/4" for Connecting Brackets  
 Unit is 3" Away From Wall

**\*\*All Measurements are Approximations\*\***

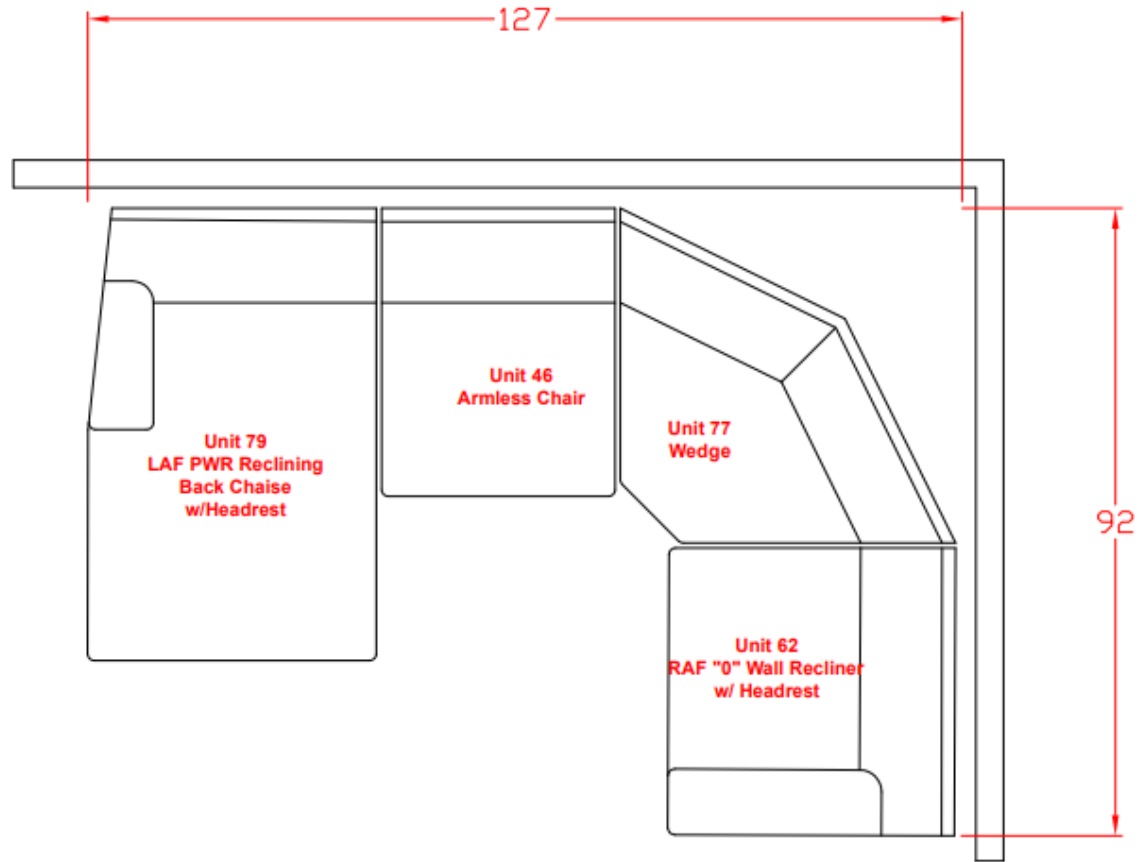

**659 Configuration 2**  
**Space Between Units = 3/4" for Connecting Brackets**  
**Unit is 3" Away From Wall**

**\*\*All Measurements are Approximations\*\***

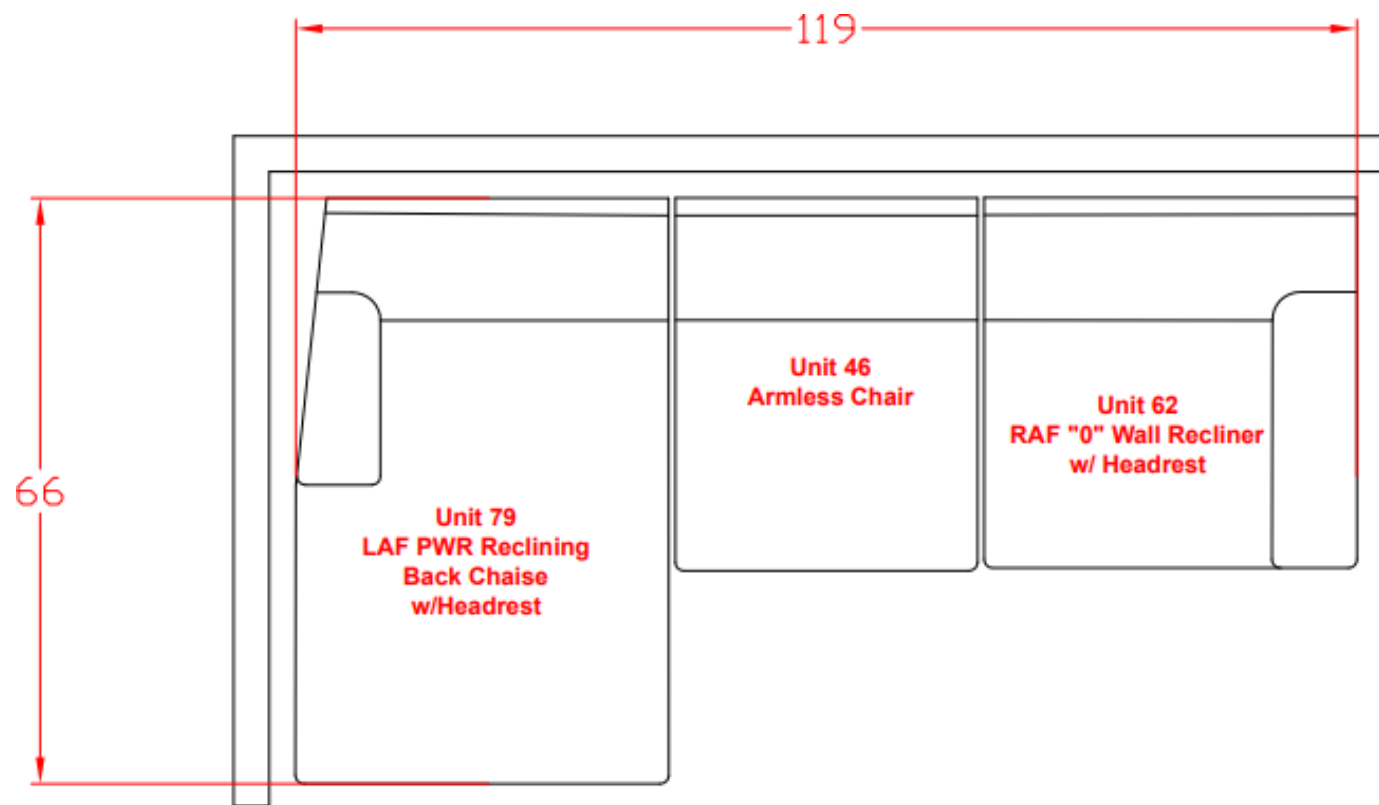

**659 Configuration 3**  
**Space Between Units = 3/4" for Connecting Brackets**  
**Unit is 3" Away From Wall**

**\*\*All Measurements are Approximations\*\***

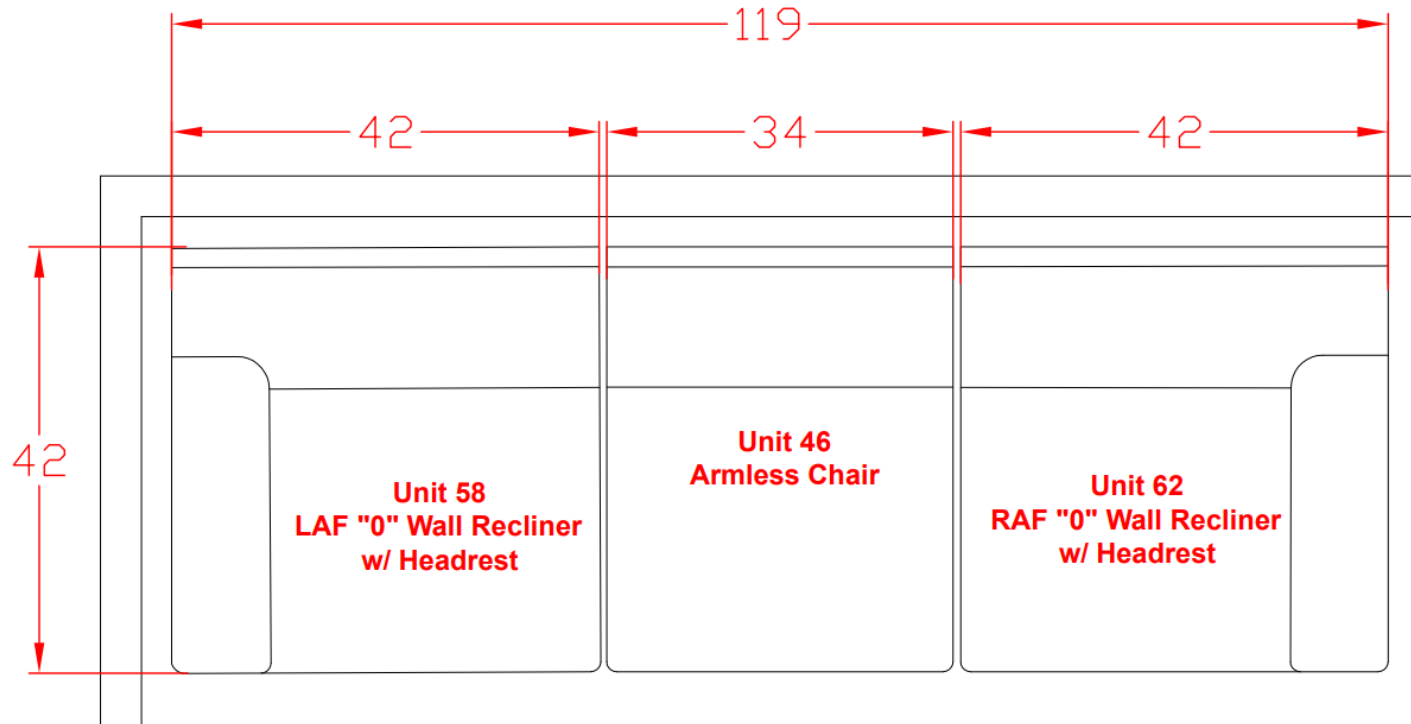

**659 Configuration 4**  
**Space Between Units = 3/4" for Connecting Brackets**  
**Unit is 3" Away From Wall**

**\*\*All Measurements are Approximations\*\***